

COMPACT-PRO 55 Tri spraying machine - Electrical box

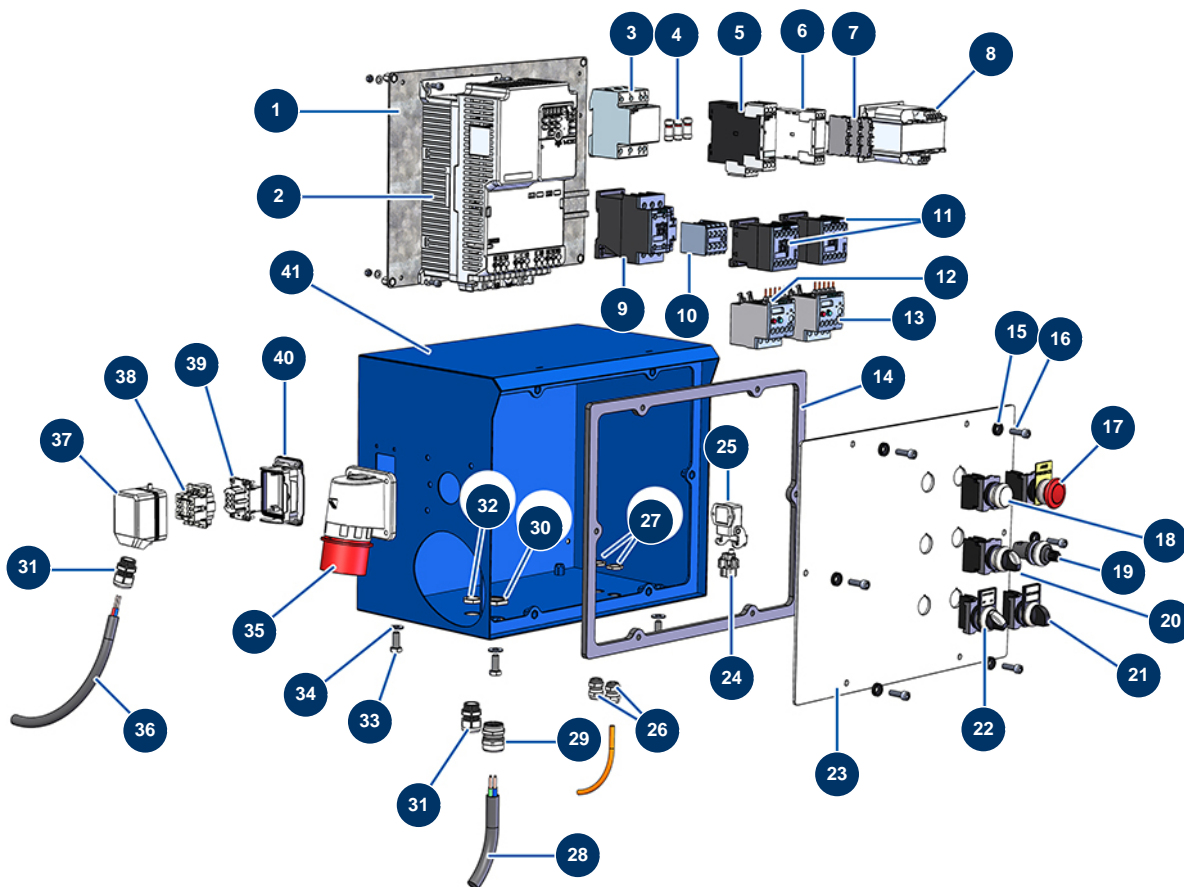

Détails des pièces

Pos.	Référence	Désignation
1	C23064	1
2	20023	400 V inverter - 5.5 KW GA
3	12149	32 A Tetra fuse holder
4	14637	Fuse 32 A AM 10.38
5	MI3C00601010	
6	20196	Auxiliary contact 2 NO 20A
7	MI3C05050800	5x20 fuse holder
8	MI3C00500402	70/80VA 400/42/24/15V transformer
9	20155	24 VAC - 4NO 32A coil contactor
10	20076	10
11	11918	Coil contactor 24 Volt AC
12	20077	Thermal protection 0.4-0.6A DILEM10 contactor
13	20078	Thermal protection 6-9A DILEM10 contactor

Pos.	Référence	Désignation
14	20025	X-PRO E50 & E100 electrical box gasket
15	80573	Hollow washer Ø 6
16	90153	6 x 30 cylindrical head screw
17	90038	Complete EMERGENCY STOP button Ø 22
18	30034	Complete ON button
19	80645	Spraying machine complete potentiometer from MARCH 2003
20	90731	3-position button
21	30025	2-position button
22	30025	2-position button
23	C22879	23
24	11914	Female insert 4p + G
25	12543	Insulating bend socket base 3p + G - 1 lever
26	90600	16 nickel plated waterproof cable gland
27	11327	Cable gland locknut of M16
28	20041	H07RNF 4G4 electrical cable by the metre
29	20043	M 25 grey plastic cable gland
30	20050	M 25 cable gland nut
31	11622	Black plastic packing M 20
31	11622	Black plastic packing M 20
32	20051	M 20 grey plastic cable gland nut
33	11544	THEF 8 x 25 screw
34	30292	ø 8 inox large washer
35	20174	
36	30018	H07RNF 4G1.5 electrical cable by the metre
37	20069	
38	20066	06 P + T male insert
39	20067	06 P + T female insert
40	20065	
41	C22876	41