

## TURBISOL 164/2 blowing machine - Electrical box

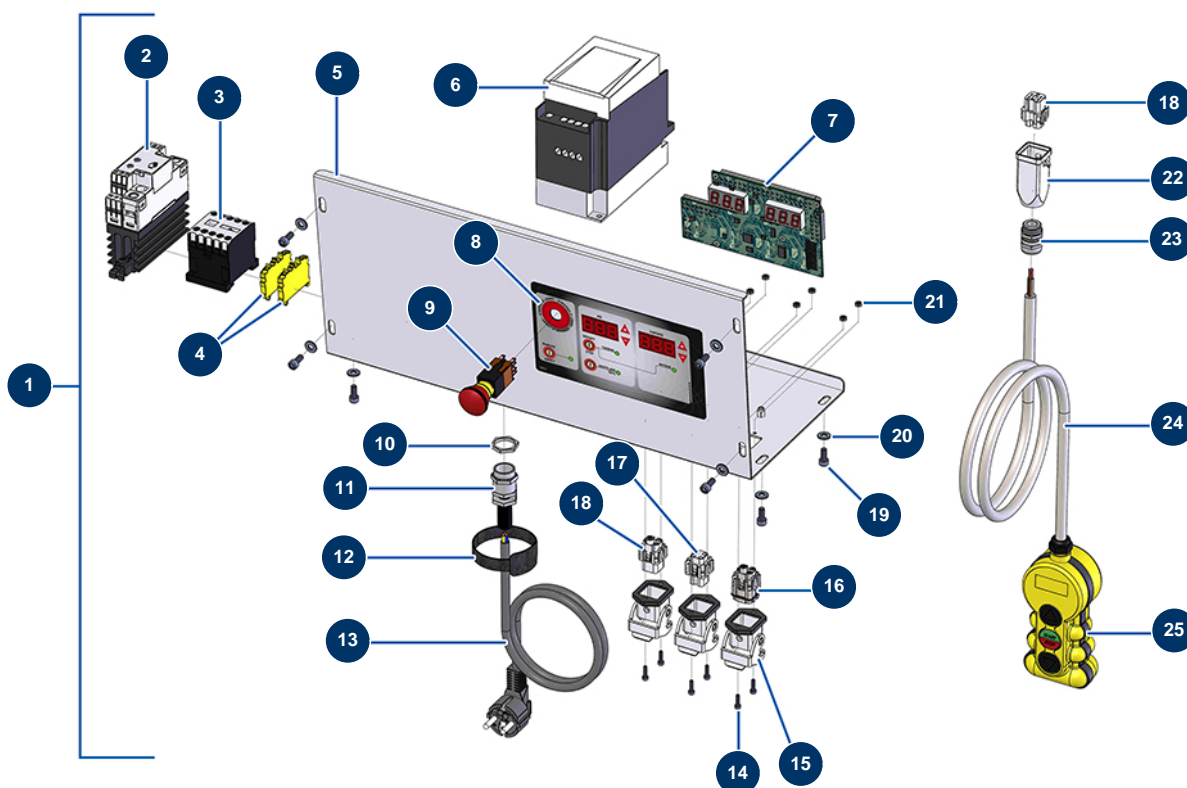

### Détails des pièces

Pos.	Référence	Désignation
1	13555	Complete membrane electrical box for TURBISOL 164/2
2	14867	30A/230V dimmer for TURBISOL 164/200
3	11918	Coil contactor 24 Volt AC
4	30038	Yellow and green conductive block 6 mm <sup>2</sup>
5	C20620	Membrane electrical box door for TURBISOL 112/2 & 164/2
6	11781	Inverter 230 V - 0,75 KW
7	30677	TURBISOL 112 & TRAMONTANE 2 blowing machine electronic card
8	13013	TURBISOL front with membrane
9	13015	Hanging EMERGENCY STOP button Ø16
10	30060	11mm cable gland nut
11	80450	cable gland for 11mm supply cable
12	12410	Self-gripping collar with loop 12,7 x 228 mm
13	90180	Supply cable with moulded plug 3G 1,5 mm <sup>2</sup>

Pos.	Référence	Désignation
14	12249	3 x 12 cylindrical head screw
15	11915	Blowing machine insulating support 3 p + T - 1 lever
16	11913	Blowing machine male insert 4 p + T
17	11912	Blowing machine female insert 3 p + T
18	11914	Female insert 4p + G
18	11914	Female insert 4p + G
19	90161	5 x 12 inox cylindrical head screw
20	11737	∅ 5 inox medium washer
21	310016	M 3 nut
22	11916	Blowing machine insulating cover 3 p + T
23	30082	Nickel plated watertight cable gland of 11
24	11919	H05VVF 4G1 grey electrical cable x 25 metres
25	11921	Blowing machine 2-button wired remote control box