

HYDROPRO 600 E airless piston pump - 5,5 kW - 400 V electrical motor conversion kit

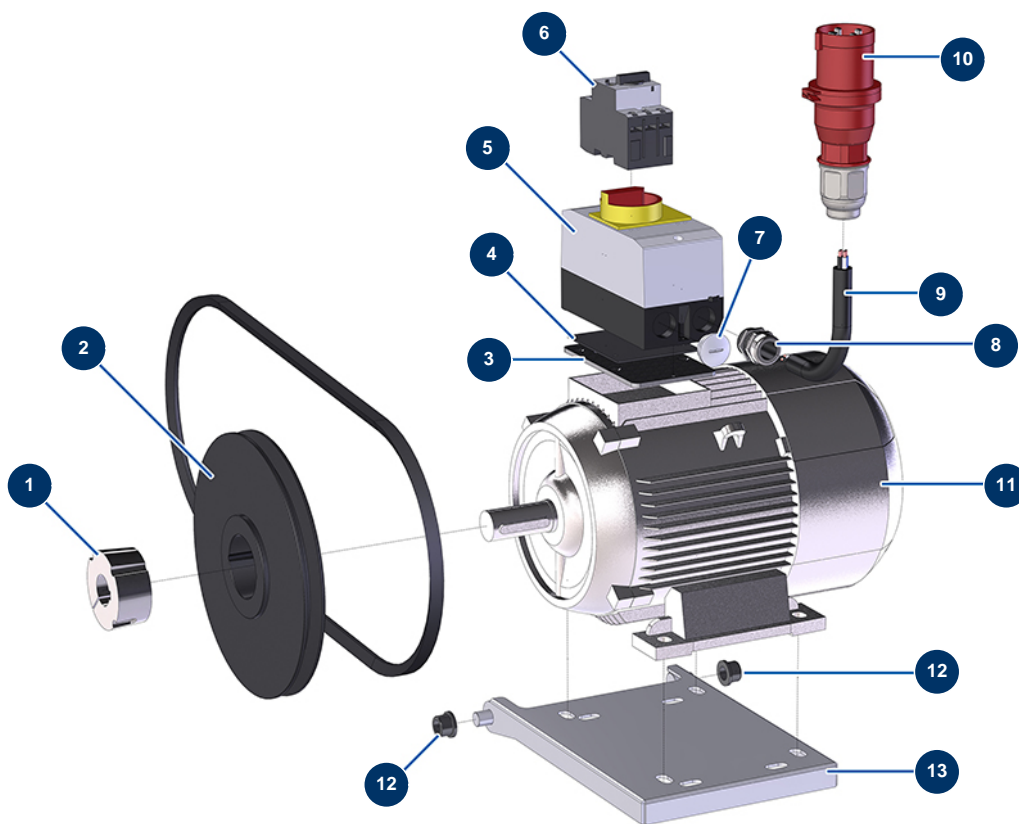

Détails des pièces

Pos.	Référence	Désignation
1	90561	Removable hub Ø 28 for 2012
2	13918	13 pulley without hub ø 236
3	11630	Moeller box new fixing plate
4	90269	EUROPRO 30,30+,36 and 40 compressor box gasket
5	30110	EUROPRO compressor vacuum switch box
6	30064	10 to 16 petrol motor circuit-breaker
7	80600	Electrical button for plastic IM 25
8	80449	Watertight cable gland of M 25
9	30019	H07RNF 4G2.5 electrical cable by the metre
10	12134	Male D electric socket 3P + T 16A with phase inverter
11	90025	Foot mounted electric motor 5,5 kW - T112 - B3 - 2800 rpm - 400V
12	14227	Bearing with flange 14/20 x 15
12	14227	Bearing with flange 14/20 x 15

Pos.	Référence	Désignation
13	C21684	HYDROPRO 600 electric motor plate