

X-PRO E70 spraying machine - 400V TETRA V2 - Hydraulic tank

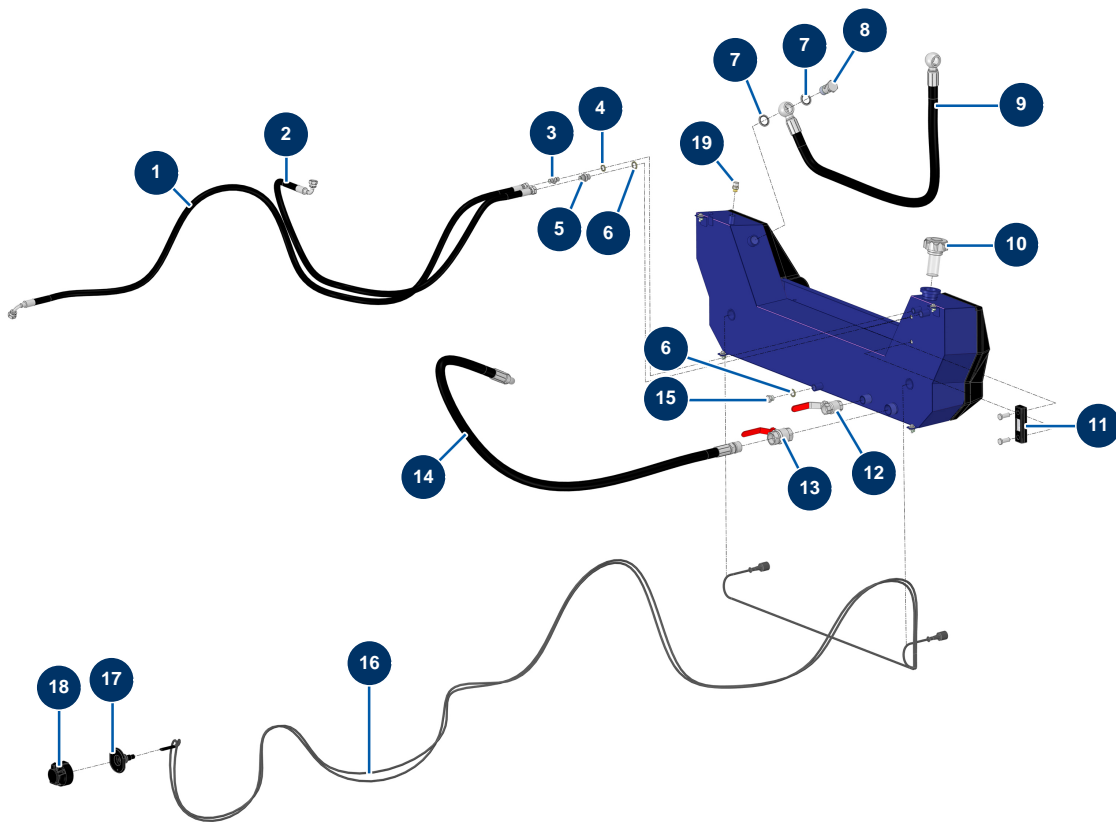

Détails des pièces

| Pos. | Référence | Désignation |
|------|-----------|--|
| 1 | 15390 | |
| 2 | 15393 | |
| 3 | 90703 | 1/4" MaleD x 1/4" MaleD high-pressure nipple |
| 4 | 91016 | Steel gasket for hollow screw with 1/4 lip |
| 5 | 90698 | 3/8" MaleD x 3/8" MaleD high-pressure nipple |
| 6 | 91031 | Steel gasket for hollow screw with 3/8 lip |
| 6 | 91031 | Steel gasket for hollow screw with 3/8 lip |
| 7 | 12573 | Steel gasket for 3/4" hollow screw with lip |
| 7 | 12573 | Steel gasket for 3/4" hollow screw with lip |
| 8 | 14733 | 3/4 BP drilled head screw |
| 9 | 15269 | |
| 10 | 15321 | |
| 11 | 12326 | Visual level of hydraulic tank - CP 60 |

| Pos. | Référence | Désignation |
|------|-----------|--|
| 12 | 11382 | Red handle valve F3/4" x F3/4" |
| 13 | 70031 | Drain valve for EUROPRO 4-6-8-14 P, MPE, AG, 7000z, 9000z |
| 14 | 15391 | |
| 15 | 90238 | 3/8" low-pressure male plug |
| 16 | 12801 | Complete lighting wiring harness 3.5 m - C.P 60 |
| 17 | 13283 | Lighting metal 7-pin female socket foam rubber gasket - C.P 60 |
| 18 | 13282 | Lighting metal 7-pin female socket - C.P 60 |
| 19 | 12504 | |